

Educational & Training Building, Delaware Technical & Community College

Wilmington, Delaware

Architect: Anderson Brown Higley Associates

Photo Courtesy of Image Source



for four departments, distance learning classrooms, and specialized programs such as Dental Hygiene, Instructional Television, and Physical/Occupational Therapy Training.

A 325-seat Conferencing Center and 100-seat Amphitheater provide state-of-the-art conferencing facilities for corporate users and community programs, in addition to functioning as classrooms. The 18-chair Dental Hygiene program provides low-cost dental services to the local community and replaces a 20-year-old facility at the south end of the site, which has been renovated into a child care center that includes student observation rooms for the College's Early Childhood Development program.

The entrance pavilion, constructed on the former Third Street, establishes a new campus entrance and links the

Delaware Technical and Community College has campuses in Wilmington, Dover, Stanton, and Georgetown, Delaware. The Wilmington campus includes the original East Building, constructed in the early 1970's, and the West Building, built in 1986. As a primary goal of the project, the client sought to create a rejuvenated, high-tech identity for the Wilmington campus.

Program requirements for the 75,000-square-foot classroom building include classrooms, science labs, faculty offices

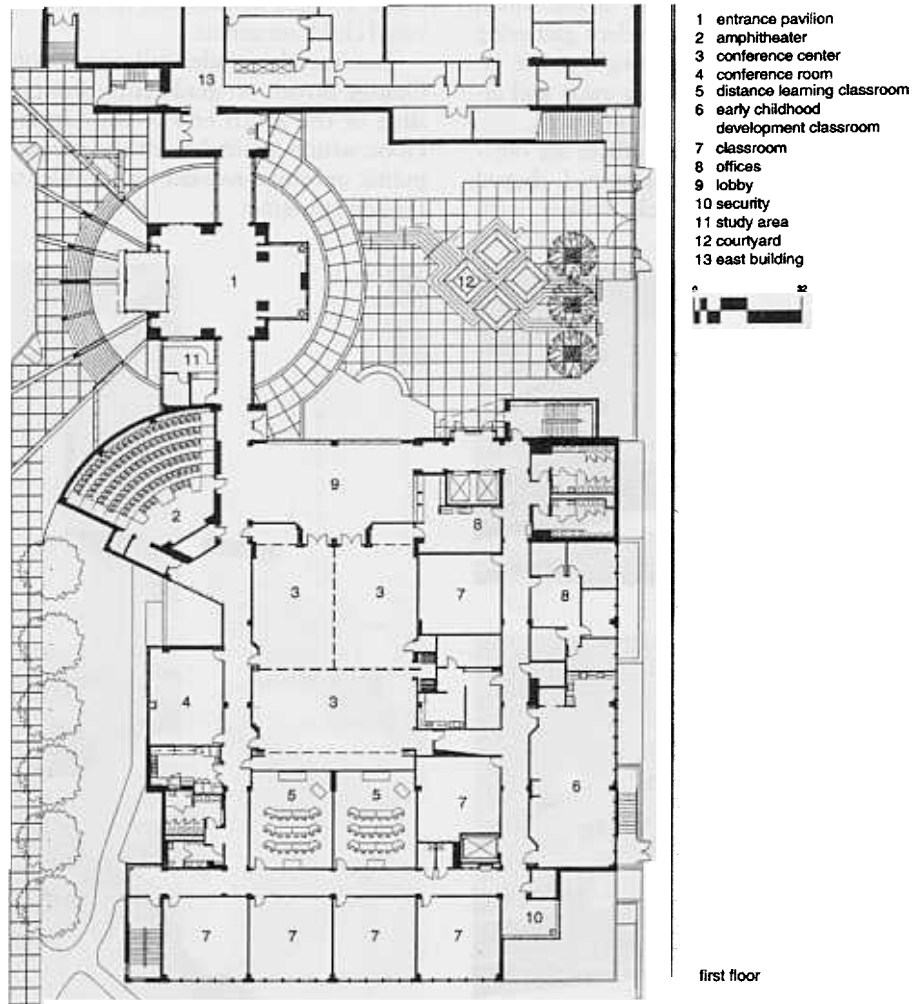

Anderson Brown Higley Associates
A R C H I T E C T S
 (302)658-6426 ABHAGEN@ABHA.com



cafeteria and bookstore spaces of the Lower Level of the East Building to the conferencing and classroom spaces of the new Educational and Training Building. Behind the pavilion, a 10,000-square-foot courtyard provides a secure outdoor gathering space for students and a venue for larger campus functions. The main stair for the building is wrapped in an aluminum curtainwall and offers views of the entrance pavilion, courtyard, and historic buildings on Market Street. Much needed casual interior student gathering spaces are integrated throughout the facility in the form of study areas and alcoves adjacent to circulation spaces.

Classrooms, labs and offices are organized in a rational three-story L-shaped building, clad in brick veneer with

modular windows. The Conferencing Center is located on the inside of the 'L' on the first floor, allowing for a clear span structure with higher ceilings, and is adjacent to the entrance for corporate users unfamiliar with the building. Public circulation spaces, study areas, and shared meeting rooms are differentiated from the classroom functions by a metal panel cladding. A dark brown brick base recalls the neighboring 5-story East Building and keeps a visual connection to the renovated childcare center.

Because the grades fall away along Orange Street, on-grade entry was possible at the south end of the Ground Floor, which is suitable for the separate public entrance needed for the Dental Hygiene program.

